

Application

- Check-in
- Repair and maintenance
- Wheel alignment
- Testing equipment

Approvals

- Major 4026-47 S:
Volvo
- Major 4026-47 W:
Volvo

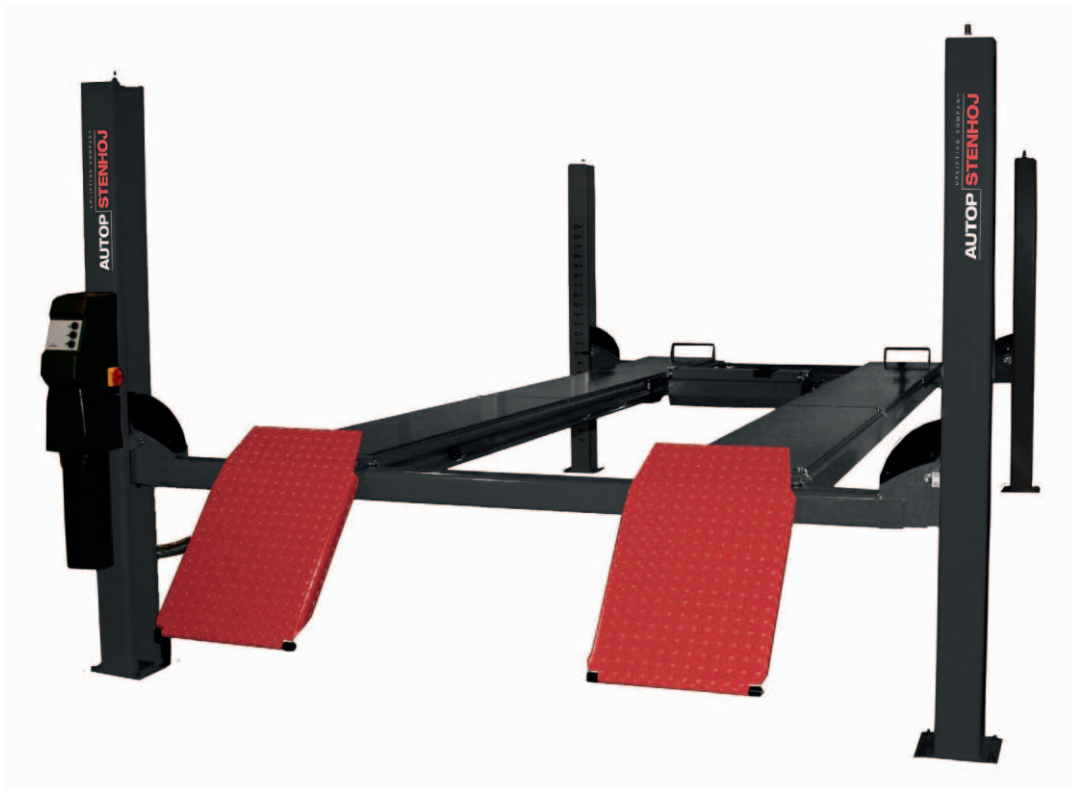

Major 4026

Electro-hydraulic 4-post lift, 4 t capacity

Description:

Posts:

- Integrated eccentric brake system
- Emergency stop valve
- Obstruction system
- Pneumatic parking system in height adjustable ratchets
- Pump and control unit on rear left post
- Pushbutton control unit with alarm signal
- Hydraulic cylinder under left platform
- Lifting and lowering by means of cables
- Emergency lowering valve

Superstructure:

- One movable platform as standard
- Platforms prepared for
AUTOPSTENHOJ Scissor jack Micro

Standard colours

- Platforms & posts: Grey RAL 7016
- Ramps: Red RAL 3020

Optional extras:

- Set of expansion bolts
- Extra control unit
- LED-Lighting set
- Set of two cover plates for recesses
- Set of two 385 mm ramp extensions
- Set of two platform extensions (0.5 m)

**Special colours available
on request!**

Technical data	
Lifting capacity	4,000 kg
Lifting height	1,670 mm
Working height	1,810 mm
Lifting / lowering time	Standard: 24 / 26 Sec. D: 16 / 26 Sec.
Pump unit	Standard: 3.0 kW D: 2 x 3.0 kW
Voltage	3x230/400V - 50 Hz - 25/16 A

Platforms	
Total length	5,060 / 5,560 mm
Usable length of platform	4,180 / 4,680 mm
Wheel base, min. - max.	variabel
Platform width	500 mm
Distance between platforms	740 - 1,030 mm
Min. height	140/160 mm
Width between posts	2,600 mm
Total width - outer edges base plates	3,022 mm
Total height	2,233 mm

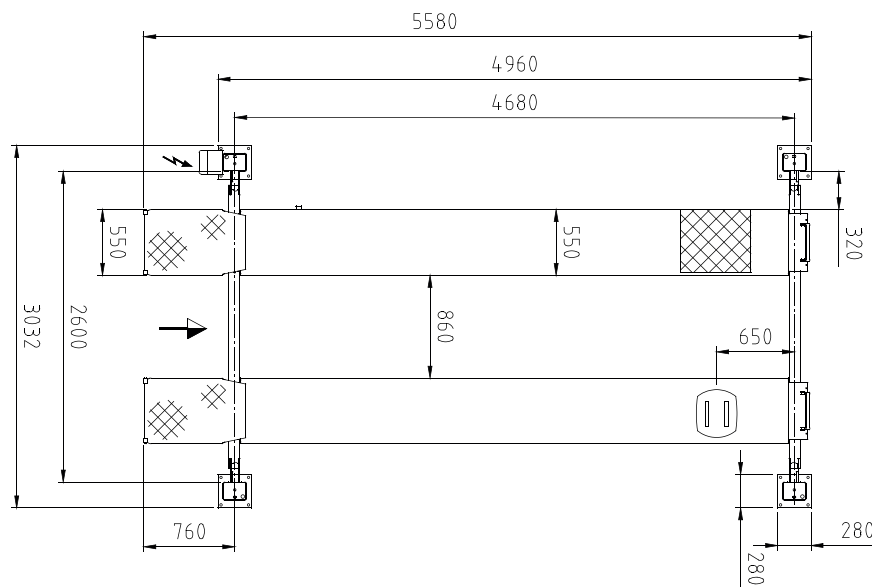
autop Maschinenbau GmbH

Sandkampstraße 90
 48432 Rheine | Germany
 ☎ +49 5971 8602-02
 📠 +49 5971 8602-25
 ✉ info@autopstenhøj.com

STENHOJ A/S

Barrit Langgade 188-190
 7150 Barrit | Denmark
 ☎ +45 76821-330
 📠 +45 76821-331
 ✉ info@autopstenhøj.com

Versions:

- Available with different Voltage
- Drive-on ramps and stops for surface-mounting, alternatively drive-over ramps for recessed installation

Installation:

- S = flush platforms
- W = with front recesses for turn tables and rear side slip plates
- G = galvanized platforms
- 42 = 4,200 mm platforms
- 47 = 4,700 mm platforms
- 51 = 5,100 mm platforms

Inspection lifts:

As standard equipped with re-inforced posts and larger cable diameter for intensive usage in inspection centres. As standard delivered with: P = play detector (pneumatically operated for both lateral and rotational movement, for axle load up to 3 t), operation with wireless hand lamp
 Option:

D = double pump unit for quicker lifting time. Control unit on front left post

MOT / ATL lifts:

Worldwide accepted inspection lifts which have been specified and constructed according to UK MOT and ATL (automated test lanes VOSA) requirements. Both MOT / ATL lifts are as standard delivered with front recesses with turntables and extra control unit for operation from front right post; ATL lifts furthermore equipped with re-inforced posts and larger cable diameter and: P = play detector (pneumatically operated for both lateral and rotational movement, for axle load up to 3 t), operation with wireless hand lamp

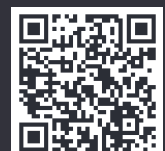
Produktdetails